

# PEELER UNIT INSTALLATION GUIDE

## Caution

This guide is provided for use by service representatives who must install the peeler unit. If the peeler is not installed, please contact your supplier.

**Note** Installation requires a cross-point ('Phillips') screwdriver with magnetic tip and a shaft at least 200 mm (8 inches) long.

- (1) Check to make sure that the printer's power switch is turned off then disconnect the power cord.
- (2) Open the top cover and lift the thermal printhead and sensor arm.

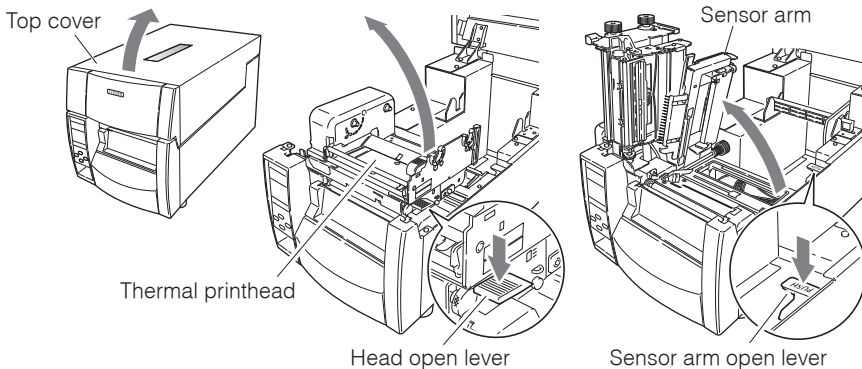

- (3) Remove the operation panel on the front of the printer. (3 screws)  
When doing this, remove the flexible cable that is connected to the operation panel.

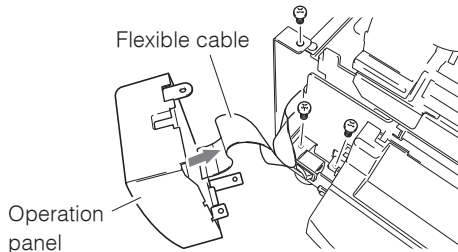

- (4) Remove the front right cover on the front of the printer. (2 screws)

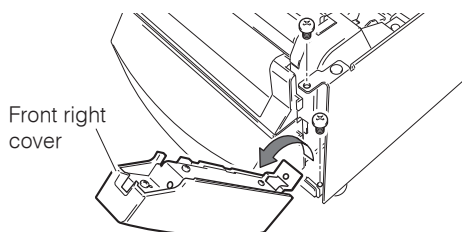

- (5) Remove the front center cover. (2 screws)

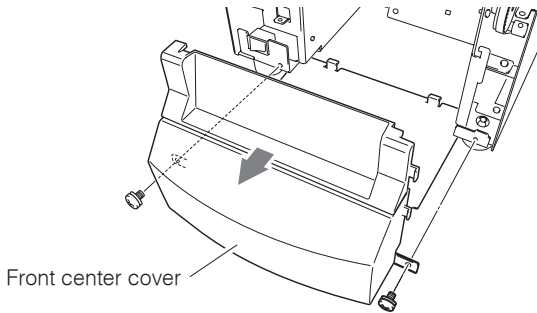

- (6) Remove the plastic cover from the front center cover that you have removed.  
(2 screws)

**Note**

The plastic cover that you have removed is needed if the peeler unit is de-installed, so store it carefully.

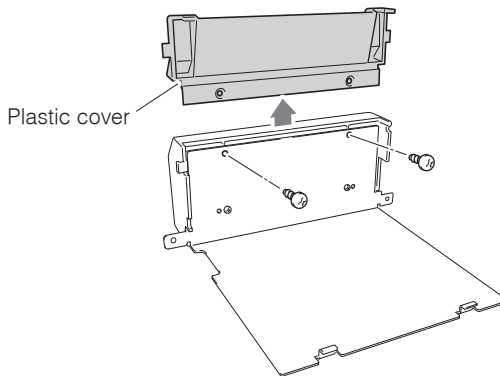

- (7) Attach the peel guide plate to the front center cover taking care not to over-tighten the screws as they are threaded in plastic. (2 screws)

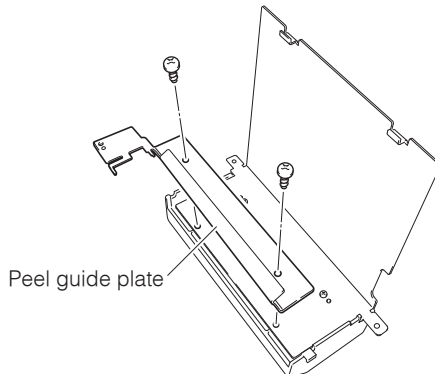

- (8) Attach the connector of the peeler unit to the daughter board as shown in the figure.

**Note**

The connector cannot be connected if it is inserted in the wrong orientation unless force is used!

Check the orientation of the connector carefully.

- (9) Slide the release knob of the peeler unit to the left and open the peeler unit.

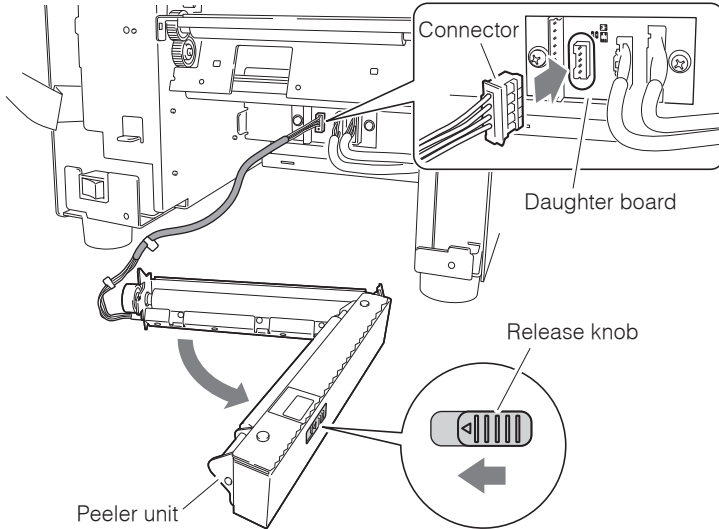

- (10) After positioning the peeler unit on the printer using the alignment pins on the peeler as a guide, fix the unit to the printer using the screw supplied. Then close the peeler.

**Note**

Be careful not to pinch the wiring harness from the peeler unit.

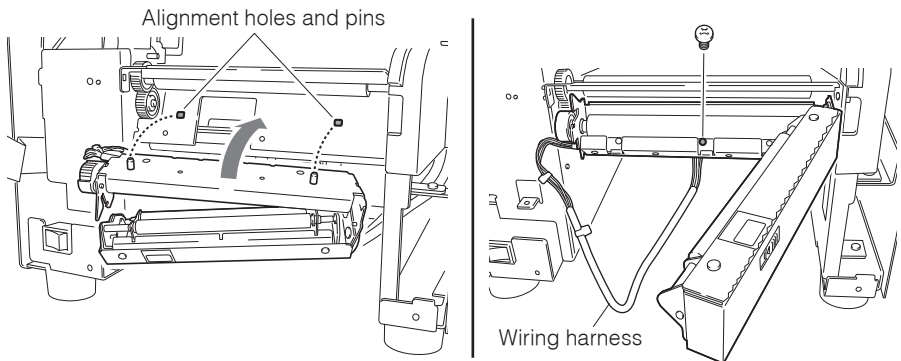

- (11) Align the two tabs on the bottom of the 'front center cover' to the slits of the printer as it is slid in to the printer. The bottom plate of the front cover needs to be held up from below to ensure a good fit. Attach the front center cover from step 5 in its original position. (3 screws, of which 1 is an accessory to the unit)

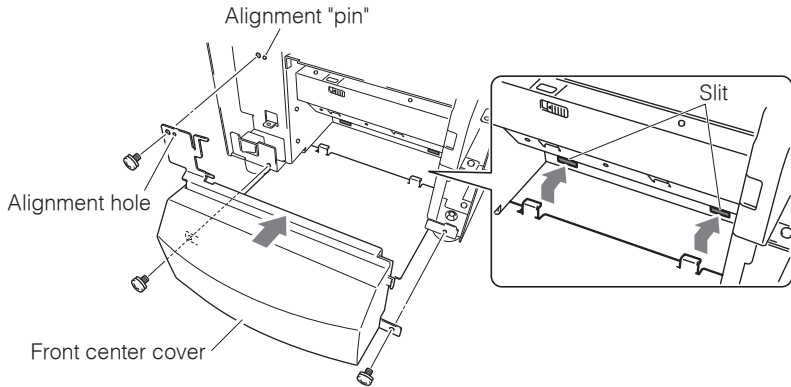

- (12) Attach the front right cover removed at step 4 in its original position. (2 screws)  
(13) Attach the operation panel removed at step 3 in its original position. (3 screws)

**Note**

Be sure to connect the flexible cable that you disconnected as it was formerly connected. The blue side of the tip is upwards.

- (14) Close the top cover.  
(15) Connect the power cord and turn on the power switch on the printer.

**Note**

**Removing the peeler unit**

To remove the peeler unit from the printer, follow the installation steps in reverse order. If the screws that fasten the peeler unit are removed, the unit may fall from the printer, so hold the peeler unit with your hand while loosening the fastening screws.

**CITIZEN SYSTEMS AMERICA CORPORATION**

363 Van Ness Way, Suite 404  
Torrance, CA 90501, USA  
Tel: (310) 781-1460  
Fax: (310) 781-9152  
<http://www.citizen-systems.com>

**CITIZEN SYSTEMS EUROPE GmbH**

Mettinger Strasse 11  
D-73728, Esslingen  
Germany  
Tel: +49 (0) 711 3906 420  
Fax: +49 (0) 711 3906 405  
<http://www.citizen-europe.com>  
Park House, 643-651 Staines Road  
Feltham, Middlesex, TW14 8PA  
United Kingdom  
Tel: +44 (0) 20 8893 1900  
Fax: +44 (0) 20 8893 0080

**CITIZEN SYSTEMS JAPAN CO., LTD.**

6-1-12, Tanashi-cho, Nishi-Tokyo-shi  
Tokyo, 188-8511, Japan  
Tel: +81 (0) 42 468 4608  
Fax: +81 (0) 42 468 4996  
<http://www.citizen-systems.co.jp>

CITIZEN is a registered trademark of CITIZEN HOLDINGS CO., Japan.  
CITIZEN es una marca registrada de CITIZEN HOLDINGS CO., Japón.  
Copyright © 2008 by CITIZEN SYSTEMS JAPAN CO., LTD.